

Auxiliary Program

Congress of Neurological Surgeons 49th Annual Meeting

Boston, Massachusetts

October 30–November 4, 1999



"The End of the Beginning"

Auxiliary Week-at-a-Glance

Saturday, October 30

| | | | |
|------|------------------|-----------------------------------|-------|
| #601 | 6:00 PM–11:00 PM | Dinner at Salem Cross Inn | \$110 |
| #602 | 7:00 PM | Boston Symphony Orchestra Concert | \$55 |

Sunday, October 31

| | | | |
|------|---------------------|--|---------------|
| | 7:30 AM–5:00 PM | Friends of the Congress Café | |
| #501 | 8:30 AM–5:00 PM | Mansions of Newport | \$69 |
| #502 | 9:00 AM–1:00 PM | Harvard University and the Glass Flowers Exhibit | \$29 |
| #503 | 9:00 AM–12:00 NOON | Boston Duck Tours: The Ride of Your Life | \$36 |
| #504 | 11:00 AM–12:00 NOON | Welcome to Boston: An Overview | Complimentary |
| #505 | 1:00 PM–5:00 PM | Complete Tour of Boston: 350 Years In A Day | \$21 |
| #506 | 1:00 PM–5:00 PM | Lexington & Concord-The Shot Heard Round The World | \$29 |
| #507 | 1:30 PM–5:00 PM | A Walking Tour of the North End | \$35 |
| | 6:30 PM–9:00 PM | Opening Reception | |

Monday, November 1

| | | | |
|------|--------------------|--|------|
| | 7:30 AM–5:00 PM | Friends of the Congress Café | |
| #508 | 9:00 AM–12:00 NOON | The Boston Design Center | \$29 |
| #509 | 9:00 AM–12:30 PM | Homes of Beacon Hill | \$55 |
| #510 | 9:30 AM–3:30 PM | A Literary Tour of Concord | \$69 |
| #511 | 11:30 AM–5:00 PM | A Thanksgiving Luncheon at Plimoth Plantation | \$62 |
| #512 | 11:30 AM–3:00 PM | Friends of the Congress Auxiliary Educational & Lunch Program | \$40 |
| #513 | 1:00 PM–4:30 PM | The Black Heritage Trail® | \$26 |
| #514 | 1:00 PM–5:00 PM | Boston Brew Pubs: The "Historic" Beer | \$54 |
| #603 | 6:00 PM–10:30 PM | A Sunset Cruise Aboard the Odyssey | \$99 |

Tuesday, November 2

| | | | |
|------|------------------|--|---------------|
| | 7:30 AM–5:00 PM | Friends of the Congress Café | |
| #515 | 8:30 AM–11:00 AM | Antique and Estate Jewelry | \$42 |
| #516 | 9:00 AM–3:30 PM | The History of Cambridge: Tory Row | \$55 |
| #517 | 9:00 AM–10:00 AM | Auxiliary Educational Session | Complimentary |
| #518 | 10:00 AM–4:30 PM | Images of Women in Art | \$84 |
| #519 | 10:00 AM–5:00 PM | Antiquing North of Boston | \$48 |
| #520 | 12:30 PM–4:30 PM | Marblehead and Old Salem: Myth and Mystery | \$35 |
| #521 | 1:00 PM–4:30 PM | Tennis | \$39 |
| #604 | 7:30 PM | Dolce Vita: The Heart of the Italian North End | \$110 |
| #605 | 7:00 PM | Riverdance | \$88 |

Wednesday, November 3

| | | | |
|------|------------------|---|---------------|
| | 7:30 AM–5:00 PM | Friends of the Congress Café | #522 |
| | 8:30 AM–9:30 AM | Auxiliary Educational Session | Complimentary |
| #523 | 9:30 AM–1:30 PM | The USS Constitution Museum & Old State House | \$29 |
| #524 | 1:30 PM–4:30 PM | A Glimpse into the Life of Victorian Boston | \$45 |
| #605 | 7:00 PM–11:00 PM | Boston Cabaret Reception and Dinner | \$100 |

Thursday, November 4

| | | | |
|--|--------------------|------------------------------|--|
| | 7:30 AM–12:00 NOON | Friends of the Congress Café | |
|--|--------------------|------------------------------|--|

Contents

| | |
|--|---|
| Auxiliary Board Officers | 4 |
| Auxiliary Board Members at Large | 4 |
| Past Presidents of the Auxiliary of the Congress of Neurological Surgeons | 5 |
| Welcome to Boston | 7 |

General Information

| | |
|---|---|
| Hospitality Suite | 8 |
| Featured Event | 8 |
| Friends of the Congress Auxiliary Educational and Lunch Program | 8 |
| Meeting Facility | 9 |
| Hotels | 9 |
| Registration | 9 |
| Tickets | 9 |
| Climate | 9 |

Getting Around

| | |
|-------------------------------------|----|
| Car Rentals | 10 |
| Tourist Information | 10 |
| Points of Interest: | 10 |
| Performing Arts | 11 |
| Restaurants- Boston Classics: | 13 |
| Restaurants-Hot Spots | 14 |
| Other Assorted Favorites: | 15 |
| Museums | 16 |
| Taverns | 17 |

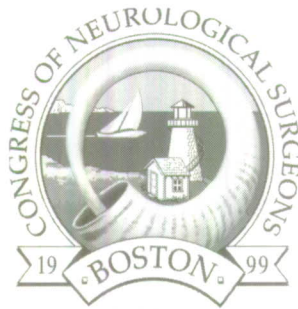

"The End of the Bevinning"

**Auxiliary of the
Congress of Neurological Surgeons
49th Annual Meeting
October 30–November 4, 1999
Boston, Massachusetts**

**Auxiliary Board Officers
1998–1999**

| | |
|-----------------------------------|---|
| President | Janet Batjer (H. Hunt Batjer) |
| President-Elect | Molly Barrow (Daniel L. Barrow) |
| Vice President | Doris McCormick (Paul C. McCormick) |
| Secretary | Lori Hadley (Mark N. Hadley) |
| Treasurer | Penny Papadopoulos (Stephen Papadopoulos) |
| Past President | Ransom Friedman (William Friedman) |
| Annual Meeting Chairman | Catherine Awad (Issam A. Awad) |
| Scientific Program Chairman | Joan Traynelis (Vincent C. Traynelis) |

Auxiliary Board Members at Large

| | |
|-------------------------------|--|
| Deborah Bean (Jim) | Jeanette Martin (Stanley) |
| Karen Camarata (Paul) | Lola Oyesiku (Nelson) |
| Lindy Camel (Mark) | Patricia Pedersen, Phd (Joseph Piepmeirer) |
| Sandy E. Ellenbogen (Richard) | Chaille Rodts (Gerald) |
| Susan Kondziolka (Douglas) | Diana Selman (Warren) |
| Karen Levy (Mike) | Sara Sirna (Christopher Loftus) |
| Barbara Mapstone (Timothy) | |

Past Presidents of the Auxiliary of the Congress of Neurological Surgeons

| | |
|----------------------------|-----------|
| Marge Schultz | 1951 |
| Nancy Svien | 1951-1952 |
| Lottie Hollister | 1952-1953 |
| Lillian Gay | 1953-1954 |
| Kay Sweeney | 1954-1955 |
| Louise Cannon | 1955-1956 |
| Nancye Marshall | 1956-1957 |
| Myrtle Tyrer | 1957-1958 |
| Lisa Gordy | 1958-1959 |
| Ann Earnest | 1959-1960 |
| Connie Kinal | 1960-1961 |
| Phyllis DeSausure | 1961-1962 |
| Marjorie Sayers | 1962-1963 |
| Mary Weiford | 1963-1964 |
| Isabel van den Noort | 1964-1965 |
| Barbara Mosberg | 1965-1966 |
| Dorothy Thompson | 1966-1967 |
| Artemis Davey | 1967-1968 |
| Katherine Sharkey | 1968-1969 |
| Dorothy Thompson | 1969-1970 |
| Betty Dohn | 1970-1971 |
| Maxine Meagher | 1971-1972 |
| Jo Patrick | 1972-1973 |
| Suzie Tindall | 1973-1974 |
| Valeria Robertson | 1974-1975 |
| Jean Ojemann | 1975-1976 |
| Suzanne Sorensen | 1976-1977 |
| Joyce Rhoton | 1977-1978 |
| Sally Kelly | 1978-1979 |
| Gloria Wilkins | 1979-1980 |
| Jane Lee | 1980-1981 |
| Anne Stewart | 1981-1982 |
| Susan Tew | 1982-1983 |
| Peggy Laws | 1983-1984 |
| Peggy Ratcheson | 1984-1985 |
| Joy Eyster | 1985-1986 |
| Ilona Quest | 1986-1987 |
| Debbie Shields | 1987-1988 |
| Barbara McWhorter | 1988-1989 |
| Donna Hankinson | 1989-1990 |
| Ilene Salcman | 1990-1991 |
| Susan Chandler | 1991-1992 |
| Dana Day | 1992-1993 |
| Debra Roski | 1993-1994 |
| Corrine Dacey | 1994-1995 |
| Lindy Camel | 1995-1996 |
| Terry Mayberg | 1996-1997 |
| Ransom Friedman | 1997-1998 |

CNS AUXILLARY PROGRAM-BOSTON 1999

Prepared by Philip Stieg

Welcome to **Boston**



BOSTON: Boston is a mix of colonial charm with urban sophistication. The John B. Hynes Convention Center is located within a 15-minute walking distance of thirteen major hotels. In addition, there is excellent public transportation and easy access to taxis. There are many superb restaurants and first-rate museums within walking distance of the Convention Center as well, giving Boston the title "America's Walking City".

Boston's popularity stems from its unique role in shaping American history. Visitors can see many of the places where the American Revolution was conceived and began: Paul Revere's House, The Boston Tea Party Ship, and The Old North Church. Many of the sites can be seen while walking a guided tour known as the Freedom Trail. There are also many reasonably priced tours that originate near the convention center.

With a wide array of diverse and interesting attractions, visitors are never at a loss for things to do. There are many museums, concert halls, theaters, nightclubs, and small cafés to fulfill your particular need. With over sixty colleges and universities, three medical schools, and 35 hospitals, Boston remains an international center of learning and intellectual development. On the lighter side, Boston offers superb professional sports attractions and musical entertainment.

There are also an abundance of site-seeing attractions surrounding Boston. Cambridge, across the Charles River, is a unique blend of culture and style. Harvard Square is a must see, with a vast array of shopping, street performers and rare bookstores. North of Boston there are many seaport towns with quaint museums and marvelous art and antique opportunities. To the West of Boston, Concord, where Paul Revere began his ride and Thoreau contemplated Walden Pond, a lovely town to visit for historical enthusiasts. Finally, southward one can visit Plimouth Plantation and visualize life, as it is re-enacted to create the environment experienced in one of the first settlements in the United States.

General Information

Hospitality Suite

The Friends of the Congress Cafe is located in the Boylston Park Room of the Sheraton Boston Hotel & Towers. All CNS Auxiliary Program registrants are invited to use the Hospitality Suite during the following hours: 7:30 AM–5:00 PM, Sunday through Wednesday, Thursday from 7:30 AM–12:00 NOON. A healthy continental breakfast will be served each morning from 7:30 AM–10:00 AM and beverages will be served throughout the day. Additional services such as Auxiliary Program ticket sales, tour information and general information about the city will be available. Stop by the CNS Friends of the Congress Cafe—it's a great place to see old friends and meet new ones! (see floor plan map on page 18).

Featured Event

Friends of the Congress Auxiliary Educational and Lunch Program

John F. Kennedy Library and Museum

11:30 AM–3:00 PM

\$40 per person

Plan to join us for this opportunity to experience the stirring legacy of President Kennedy's thousand days, and come away inspired by his vision that each person in our society can make a difference and that everyone should try. You are invited to view the Library's permanent collection on the life and legacy of President John F. Kennedy. The museum features three theaters, period settings and twenty dramatic exhibits drawing on rare film and television footage, historic Presidential documents, personal family keepsakes, treasures from the White House, and gifts throughout the world. After enjoying a delightful lunch viewing a spectacular panoramic view of the Boston Harbor and skyline you will get the unique opportunity to hear from the museum's curator who will provide you with historical information regarding the Kennedy family.

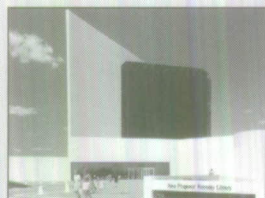

Don't miss this special event - register today for this program! This program is co-sponsored by the CNS.



Meeting Facility

John B. Hynes Veterans Convention Center

900 Boylston Street – (617) 954-2000

Hotels

Boston Back Bay Hilton – 40 Dalton Street Phone – (617) 236-1100

Boston Park Plaza Hotel – 64 Arlington Street – (617) 426-2000

Boston Marriott Copley – 10 Huntington Avenue – (617) 236-5800

The Colonnade – 120 Huntington Avenue – (617) 424-7000

Copley Square Hotel – 17 Huntington Avenue – (617) 536-9000

The Fairmont Copley Plaza – 138 St. James Avenue – (617) 267-5300

Four Seasons Hotel – 200 Boylston Street – (617) 338-4400

The Lenox Hotel – 710 Boylston Street – (617) 536-5300

Radisson Hotel Boston – 200 Stewart Street – (617) 482-1800

Sheraton Boston Hotel and Towers – 39 Dalton Street – (617) 236-2000

Swissotel Boston – One Avenue de Lafayette – (617) 422-5533

Westin Copley Place – 10 Huntington Avenue – (617) 424-7481

Registration

Registration will take place at the John B. Hynes Convention Center. To register for the Auxiliary Program or purchase a ticket for a social event, guests must go to the Registration Area at the Convention Center. Registration will be open during the following hours: Sunday through Wednesday from 7:00 AM–5:30 PM and Thursday from 7:00 AM–11:00 AM. If a registered guest would like to purchase a tour ticket, they may stop by the Hospitality Desk located in the Friends of the Congress Café during the following hours: Sunday through Wednesday from 7:30 AM–1:00 PM.

All registered guests are required to wear their name badge to be admitted into the Friends of the Congress Cafe and the Exhibit Hall.

Children over the age of 12 may register as a guest at the Guest Registration fee. This will allow full participation in Auxiliary Program activities, however, children under the age of 18 are not allowed in the Exhibit Hall.

Tickets

All tours, courses, and social events require a ticket. For events that still have openings, tickets may be purchased in the CNS Registration Area. Tour tickets can also be purchased at the Hospitality Desk located in the Friends of the Congress Café.

Climate

Boston's weather is highly variable from season to season; even day to day. It is usually fairly chilly toward the end of October in Boston (40's-50's), but you never know, especially given the shifts in weather patterns with El Niño. We advise tuning in to a reliable national weather forecast, planning for the worst, and hoping for the best.

Getting Around

Car Rentals

The major car rental companies are:

800 Numbers

Avis Rent A Car (800) 331-1212

Budget (800) 527-0700

Hertz (800) 654-3131

Thrifty Car Rental (800) FOR-CARS

Downtown

(617) 561-3500

(617) 497-1800

(617) 561-3000

(617) 634-7350

Tourist Information

Greater Boston Convention & Visitors Bureau

Two Copley Place, Suite 105

Phone (617) 536-4100

Points of Interest:

- **Old North Church** *193 Salem St., Boston, MA 02113*, (617) 523-6676. This is the church where the two lanterns were hung to warn that the British were coming by sea before the American Revolution began.
- **Bunker Hill Monument** *Monument Sq., Charlestown, MA 02129*, (617) 242-5641. One of the earliest sites of the Revolutionary War, this site saw the killing of half the British troops. Visit the museum and 221 foot obelisk.
- **Emerald Necklace** A seven-mile ribbon of nine interconnected parks that was designed by Frederick Law Olmsted as a place for people to slow down and enjoy a break from life's hectic pace.
- **Boston Park Rangers** *1010 Massachusetts Ave., Boston, MA 02118*. (617) 635-7383. The Boston Park Rangers offer an array tours that start from various sites throughout the city. They know all the sites in Boston from the most public to most secret. A schedule of the times and types of tours is available from the center.
- **Faneuil Hall** *Faneuil Hall Square, Boston, MA 02109*, (617) 242-5675. Known as the "Cradle of Liberty", it was the main rallying site at the start of the revolution. Many impassioned speakers have gathered here to have the chance to speak their point view. Renovated in the 1970s, it is now an urban marketplace with many different shops, restaurants and outdoor entertainment.

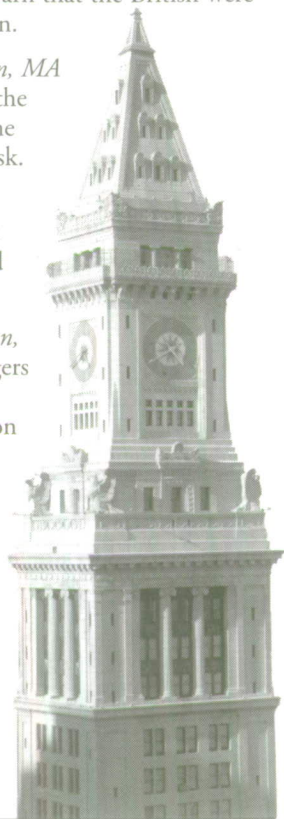

- **Frederick Law Olmsted National Historic Site** 99 Warren St., Brookline, MA 02146, (617) 566-1689. Frederick Law Olmsted was one of the most influential landscape architects in the country. The grounds of Frederick Law Olmsted's private residence and workshop embody his principles of landscape design in miniature.
- **Freedom Trail** 15 State St., Boston, MA 02109, (617) 242-5642. The famous red line in the sidewalk leads to many of Boston's principal historic sites, many of which have free admission. Tours start from the National Park Service Visitors Center.
- **John Hancock Tower and Observatory** 200 Clarendon St., Boston, MA 02116, (617) 247-1977. The tallest building in Boston is characterized by its rhomboid structure. Located in Copley Square, the structure was built in 1976 by I.M. Pei.
- **Mayflower II** Water St., Plymouth, MA 02362, (508) 746-1622. A full-scale replica of the ship that brought over the founding fathers of the country.
- **Mount Auburn Cemetery** 580 Mount Auburn St., Cambridge, MA 02138, (617) 547-7105. America's first garden cemetery, it is still in operation. It is home to many unusual monuments as well as 580 varieties of trees and more than 30,000 annuals.
- **King's Chapel and Burying Ground** 58 Tremont St., Boston, MA 02108 at School Street, (617) 227-2155. America's first Unitarian church and cemetery. Many of Boston's earliest settlers are buried here.

Performing Arts

- **The Charles Playhouse** 74 Warrenton St., Boston, MA 02116, near Stuart Street, (617) 426-6912. Once a speak-easy, the 156 year old Charles Playhouse was originally built as a Universalist Church. Consisting of two theaters, one a cabaret style theater in the basement and the other a more traditional theater seating up to 500. Parking is available in the Transportation Building.
Shear Madness: Year-round show times: Tuesday - Friday, 8:00pm; Saturday, 6:30pm and 9:30pm; Sunday, 3:00pm and 7:30pm; No Monday shows. *Blue Man Group*: Ongoing: Wednesday - Thursday, 8:00 pm; Friday -Saturday, 7:00pm and 10:00pm; Sunday, 3:00pm and 6:00pm. *Emerson Explosion*: Wednesdays at 9:45pm; *Friday Night Live Music*: 11:45pm; *Saturday Night Live Music* at 11:45pm; *Thursday Night Live Music* at 9:45pm. *Hours (for box office)* Monday: 10:00am - 6:00pm; Tuesday - Thursday: 10:00am - 8:00pm, Friday - Saturday: 10:00am - 10:00pm, Sunday: 12:00noon - 6:00pm.
- **Colonial Theatre**, 106 Boylston St., Boston, MA 02116, near Tremont Street, (617) 426-9366. A comfortable, moderately scaled venue, the Colonial is the oldest continuously operating theater in Boston. Clarence Blackall designed the theater in 1900. Featuring Italian marble walls, wraparound balconies, three spectacular chandeliers as well as a 40,000-piece mosaic tile vestibule, this theater is a classic example of the opulence one would expect of a theater. Its fan-shaped auditorium seats 1,658, with each seat providing an excellent, unobstructed view of the stage.

- **Fleet Center** *Causeway St., Boston, MA 02114, off Canal Street,* (617) 624-1050. The FleetCenter is Boston's answer to the sports arena. Home to the Celtics and Bruins, every seat is comfortable and offers a good view. The parquet on the floor will remind you of days gone by, but the temperature-controlled climate and an excellent sound system are two of the creature comforts offered by this new arena. The FleetCenter has over 100 luxury skyboxes and a maximum seating capacity of nearly 20,000. A state of the art scoreboard was also installed when this arena was built in 1995. Those who've bought exclusive premium seats will have the added benefits of waitstaff bringing food and drinks right to their seats, the option of dining in the Premium Restaurant and checking out the Sports Museum of New England. The arena is also host to some the biggest selling names in music as well as many other special events offered throughout the year.
- **Jordan Hall** *290 Huntington Ave., Boston, MA 02115, at Gainsborough Street,* (617) 262-1120. Jordan Hall, part of the New England Conservatory campus, is known world wide for its acoustic perfection. With a seating capacity of 1,013, the hall is host to both faculty and student recitals as well as professional concerts by the likes of Yo-Yo Ma, Stan Getz and the Vienna Boys Choir. Built in 1903, the hall was designated as a National Historic Landmark in 1994. The Hall underwent a major renovation in 1995, its first in fifty years. Hours (box office) Weekdays: 10:00am – 6:00pm; Saturday: 12:00noon – 6:00pm; Sunday: open only on concert days, 1 1/2 hours before performance. Tickets sold are for same-day performances only.
- **Symphony Hall** *301 Massachusetts Ave., Boston, MA 02115, at Huntington Avenue,* (617) 266-1492. The acoustically magnificent home to the Boston Symphony Orchestra, the Boston Pops, and numerous performances in the annual BankBoston Celebrity Series, seats 2,626. Classic and elegant, the brass, leather and goldleaf are not as heavy as you would normally find in the architectural designs of the Italian Renaissance style. Textiles were used to help muffle sounds and provide better resonance throughout the hall. The Hall is infamous for its uncomfortable, wooden seats, but offers unobstructed views from any vantagepoint. Recently renovated, the Hall is cleaner than in previous years and had many modifications made to the infrastructure of the building. Hours (for box office) Monday - Saturday: 10:00am – 6:00pm; Sunday: closed (unless there is a concert).



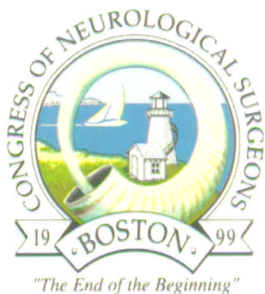

Dr. H. Hunt Batjer
requests the pleasure of your company
at the
Congress of Neurological Surgeons
International Reception
Wednesday, November 3, 1999
5:30 pm–6:30 pm
Constitution Ballroom
Sheraton Boston Hotel & Towers

Co-sponsored by Lippincott Williams & Wilkins

- **Wang Center for the Performing Arts** 270 Tremont St., Boston, MA 02116, (617) 482-9393. Located in the heart of the theater district, the Wang Center underwent a major renovation in 1983 which was financed by computer magnate An Wang. Modeled after the Palace of Versailles, it features a 100-foot domed ceiling and grand staircase in its Grand Lobby. The Wang theater also has one of the five largest stages in the country. At various times throughout its history it has operated as a movie house, home to big band performances as well as its current incarnation as home to the Boston Ballet. It also hosts various other theater productions throughout the year. Hours (for box office) Monday - Saturday: 10:00am - 6:00pm; Sunday: closed.
- **Shubert Theatre** 265 Tremont St., Boston, MA 02116, near Stuart Street, Located directly across the street from the Wang Center, (617) 482-9393. Also recently renovated, the 1,600+ seat venue boasts plush red carpets and a wonderful chandelier. Under the same management that handles the Wang Center, the Shubert is host to many plays and musicals. Hours (for box office) Monday - Saturday: 10:00am - 6:00pm; Sunday: closed

Restaurants- Boston Classics:

- **Aujourd'hui** 200 Boylston St., Four Seasons Hotel, Boston, MA, 02116, between Arlington and Charles Streets, (617) 351-2072. A four star experience that relishes formal dining, Aujourd'hui is one of Boston's last luxury restaurants. Executive Chef Edward Gannon starts off with a French influence and adds touches of international influences to create a wonderful menu. The restaurant also boasts a huge international wine list sure to please any connoisseur Hours: Weekdays: 6:30am - 11:00am, 11:30am - 2:00pm, 5:30pm - 10:00pm; Saturday: 7:00am - 12:00noon, 5:30pm - 10:00pm; Sunday: 7am - 11am, 11:30am - 2pm, 6pm - 10pm. \$\$\$\$
- **Bull & Finch Pub** ("Cheers") 84 Beacon St., Boston, MA 02108, Between Charles and Arlington Streets, (617) 227-9605. Believe it or not this has become Boston's most-visited tourist destination. Check out the bar that the hit TV show "Cheers" made famous. While you're there check out their menu that offers up all-American bar food including what some call the best burger in Boston. No reservations accepted. Hours Daily: 11:00am - 2:00am (food is served from 11:00am - 11:45 pm). \$
- **Durgin-Park** 340 Faneuil Hall Marketplace, Boston, MA 02109, (617) 227-2038. Down-to-earth and casual, known for its lovably gruff waitstaff, Durgin-Park offers up classic New England Fare. Start with the Clam Chowder, move on to the Yankee pot roast and finish with apple pie. A live piano player twinkles the keys nightly. Hours: Monday - Thursday: 11:30am - 10:00pm; Friday - Saturday: 11:30am - 10:30pm; Sunday: 11:30am - 9:00pm. \$\$



- **Seasons** *The Regal Bostonian, Faneuil Hall Marketplace, Boston, MA 02109* (617) 523-4119. Executive Chef Michael Taylor offers up seasonal menus that are complimented by an extensive wine list. Its been rated 4 ½ stars by Boston's top newspaper and rated as one of the top 50 restaurants by Conde Nast Traveler. \$\$\$
- **Union Oyster House** *41 Union Street, Boston, MA 02108* (617) 227-2750. The oldest continuously operating restaurant in the United States, it opened its doors in 1826. New England seafood offered in large servings perfect with a glass of beer. Hours: Sunday – Thursday: 11:00am – 9:30pm; Friday – Saturday: 11:00am – 10:00pm; Raw Bar opened until 12:00 midnight. \$\$

Restaurants-Hot Spots

- **Clio** *Eliot Suite Hotel, 370 Commonwealth Avenue, (617) 267-1607.* Contemporary French cuisine with an Asian influence is offered at Clio's which was voted as the Best restaurant in Boston two years in a row. This is definitely one of Boston's most popular restaurants. \$\$\$
- **Mistral** *223 Columbus Ave., Boston, MA 02116, At Berkeley Street,* (617) 867-9300. Funky, Mediterranean décor characterizes this bistro. Be sure to call two to three weeks in advance to get a reservation. Thursday – Saturday nights. Your best chance of getting in is Sunday night. Hours: Sunday - Thursday: 5:30pm – 12:00 midnight, Saturday: 5:30pm - 12:45am. Bar closes at 1:00am. \$\$\$\$
- **Oak Room,** *Fairmont Copley Plaza Hotel, 138 St. James Ave, Boston, MA 02116* (617) 267-5300. A classic, expensive steakhouse serving exquisite steaks and seafood in an upscale, traditional décor. It offers an ala carte menu with generous servings as well as impeccable service. A true classic. Hours Sunday - Thursday: 5:30pm – 10:00pm, Friday - Saturday: 5:30pm – 11:00pm. \$\$\$\$
- **Olives** *10 City Square, Charlestown, MA 02129 At Park Street,* (617) 242-1999. Its lavish décor and food will make this restaurant a culinary delight. The blend of tastes in one bite will amaze you. Delightful, flavorful food is served in large portions and in a wonderful ambiance. Hours: Tuesday - Friday: 5:30pm - 10:35pm; Saturday: 5:00pm - 10:30pm; Sunday - Monday: closed. Reservations accepted for parties of six or more only. \$\$\$\$
- **Les Zygomates Wine Bar & Bistro** *129 South St., Boston, MA 02111, Between Kneeland and Essex Streets,* (617) 542-5108. A true French bistro, the food and wine list at this restaurant is enough to please any francophile. Rich, traditional bistro fare, some with a twist, is served in perfectly sized portions. Live jazz is offered Tuesdays through Fridays. Monday - Friday: 11:30am – 1:00am, Saturday - Sunday: 6:00pm – 1:00am.



Other Assorted Favorites:

- **Biba** 272 *Boylston St., Boston, MA, Between Arlington and Charles Streets,* (617) 426-7878. An eclectic and creative menu is served in laid-back yet lavish ambiance. Head chef Lydia Shire, or co-chef Susan Regis often wander around checking on customer satisfaction. Hours: Sunday - Thursday: 11:30am - 2:30pm; 5:30pm - 10pm Friday: 11:30am - 2:30pm; 5:30pm - 11pm, Saturday: 5:30pm - 11pm, Bar open till 2am daily; bar food till midnight. \$\$\$\$
- **The Cottonwood Restaurant and Café** 222 *Berkeley St., Boston, MA, at St. James Street,* (617) 247-2225. An American menu with Southwestern hints. Hours: Monday - Thursday: 11:30am - 2:30pm, 5:30pm - 10:00pm; Friday: 11:30am - 2:30pm, 5:30pm - 11:00pm; Saturday: 11:00am - 3:00pm, 5:30pm - 11:00pm, Sunday: 11:00am - 3:00pm, 5:00pm - 9:00pm. \$\$\$
- **Grill 23 & Bar** 161 *Berkeley St., Boston, MA,* (617) 542-2255. A grand steakhouse with a few nice surprises thrown in. Hours: Monday - Thursday: 5:30pm - 10:30pm, Friday - Saturday: 5:30pm - 11pm, Sunday: 5:30pm - 10pm. \$\$\$\$
- **Harvest** 44 *Brattle St., Cambridge, MA 02138,* (617) 868-2255. Nouvelle American. Hours: Monday - Wednesday: 11:30am - 11pm Thursday - Saturday: 11:30am - midnight Sunday: 5:30pm - 10:30pm. \$\$\$
- **The Hungry I** 71½ *Charles St., Boston, MA 02114,* (617) 227-3524. French, Continental. The emphasis is on exotic dishes. Hours: Monday - Saturday: 6pm - 9:30pm Sunday: 11am - 2pm; 6pm - 9:30pm. \$\$\$\$
- **Rialto** *The Charles Hotel, One Bennett Street, Cambridge, MA 02138,* (617) 661-5050. French, Italian and Spanish dishes nightly to much acclaim. \$\$\$\$
- **Vinny Testa's Bar & Ristorante** 867 *Boylston St., Boston, MA,* (617) 262-6699. American Fare. If your server draws your table number out of a bottle at the end of dinner, your bill is on the house. Family friendly. Hours: Monday - Saturday: 11:30am - midnight. Sunday: 11:30am-11pm. Reservations accepted for parties of six or more. \$\$



Museums

- **Boston Tea Party Ship & Museum** *Congress Street Bridge, Boston, MA 02110, (617) 338-1773. Daily: 9:00am – 5:00pm.*
- **Computer Museum** *300 Congress Street, Boston, MA 02110, (617) 423-6758. Daily: 10:00am – 6:00pm.*
- **USS Constitution Museum** *Charlestown Navy Yard, Charlestown, MA 02129, off Constitution Road, (617) 426-1812. Daily: 9:00am – 6:00pm*
- **Children's Museum** *300 Congress St., Boston, MA 02210, (617) 426-8855. Daily: 10:00am – 5:00pm, Friday: 10:00am – 9:00pm*
- **Museum of Fine Arts** *465 Huntington Ave., Boston, MA 02115, (617) 267-9300. Monday, Tuesday, Thursday, Friday: 10:00am – 4:45pm, Wednesday: 10:00am – 9:45pm, Saturday, Sunday: 10:00am – 5:45pm*
- **Isabella Stuart Gardner Museum:** *280 The Fenway, Boston, MA 02155, at Huntington Avenue, (617) 566-1401. Hours: Tuesday – Sunday: 11:00am- 5:00pm, Closed Monday*
- **Museum of Science** *Science Park, Boston, MA 02114, off Route 28, (617) 723-2500. Saturday – Thursday: 9:00am – 5:00pm, Friday: 9:00am – 9:00 pm*
- **New England Aquarium** *Central Wharf, Boston, MA 02110, (617) 973-5205. Monday, Tuesday, Friday: 9:00am – 6:00pm, Wednesday: 9:00am – 8:00pm, Saturday, Sunday: 9:00am – 7:00pm*
- **Old State House** *Bostonian 206 Washington St., Boston, MA 02109, (617) 720-3290. Daily: 9:00am – 5:00pm*
- **John F. Kennedy Library & Museum** *Columbia Pt., Boston, MA 02125, (617) 929-4500. Daily: 9:00am – 5:00pm. Walking tours on Mondays*
- **Paul Revere House** *19 North Square, Boston, MA 02113, (617) 523-2338. October: Daily: 9:30am – 5:15pm, November: Daily: 9:30am – 4:15pm*
- **Salem Wax Museum** *288 Derby St., Salem, MA 01970, (978) 740-2929. Daily: 9:00am – 6:00pm*
- **Salem Witch Museum** *19½ Washington Square, Salem, MA 01970, (978) 744-1692. Daily: 10:00am – 5:00pm*
- **New England Pirate Museum** *274 Derby Street, Salem, MA 01970, (978) 741-2800. Daily: 10:00am – 5:00pm*

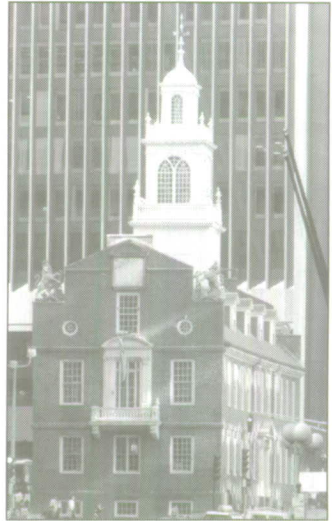

Taverns

- **Back Bay Brewing Company** 755 *Boylston St., Boston, MA 02116, between Exeter and Fairfield Streets*, (617) 424-8300. Brewer Tod Mott creates some of Boston's best beer. A hip, stylish brewpub. Hours: Monday - Saturday: 11:30am - 12:00am midnight, Sunday: 11:00am - 12:00midnight. Club open until 1:00am. Reservations accepted for parties of 6 or more. \$\$
- **L Street Tavern** 658 *E 8th St., # A, South Boston, MA 02127*, (617) 268-4335. The tavern where "Good Will Hunting" was filmed. Hours: Monday - Saturday: 8:00am - 1:00am, Sunday: 12:00noon - 1:00am
- **Samuel Adams Brew House** 710 *Boylston St., Boston, MA 02116, At Exeter Street*, (617) 536-2739. Though an offshoot of the actual brewery, this is still a great place to taste some of the best and freshest microbrew beer around. Plus, for a small fee, you can take a trolley to the brewery and perhaps take part in a test-run of a new beer recipe. Daily: 11:00am - 2:00am.
- **John Harvard's Brew House** 33 *Dunster St., Cambridge, MA 02138, between Mass. Ave. and Mount Auburn Street*, (617) 868-3585. Winner two years in a row of the best microbrewery in Boston. This Brew House serves up great beer as well as a better than average menu from Chef Frank L'Heureux. There's also live jazz and folk music on Sundays and Mondays. Hours: Monday - Wednesday: 11:30am - 1am (kitchen closes at 10pm) Thursday - Saturday: 11am - 2am (kitchen closes at 11pm) Sunday: 11:30am - 12:30pm (kitchen closes at 10pm) Reservations accepted for parties of eight or more only. \$\$
- **North East Brewing Company** 1314 *Commonwealth Ave., Boston, MA 02134, at Redford Street*, (617) 566-6699. This brewpub allows you to watch the beer making process with the copper tanks on center stage in the center and rear of the establishment. The pilsner won a silver medal in the 1998 World Beer Championship. Enjoy either barfood or more sophisticated food including pasta and grilled dishes. Live entertainment is offered Wednesdays - Saturdays. Hours: Monday - Friday: 4:00pm - 1:00am; Saturday: 11:00am - 1:00am; Sunday: 10:00am - 1:00am. \$\$



Sheraton Boston Hotel and Towers Hotel Map

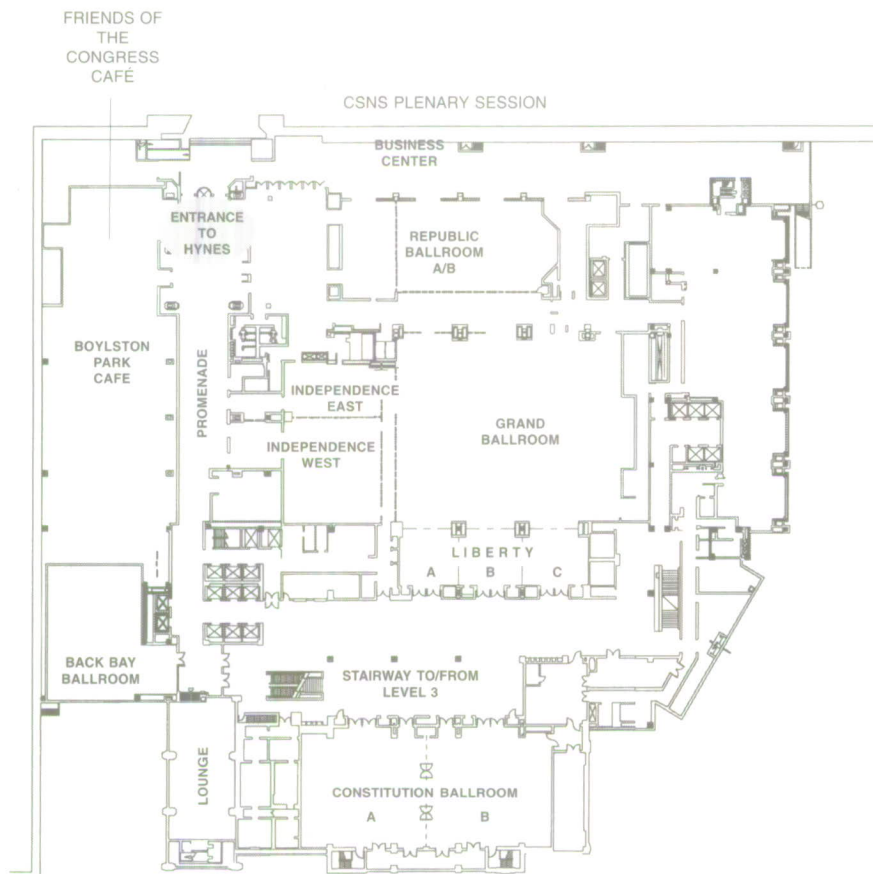

PLAZA LEVEL-2ND FLOOR

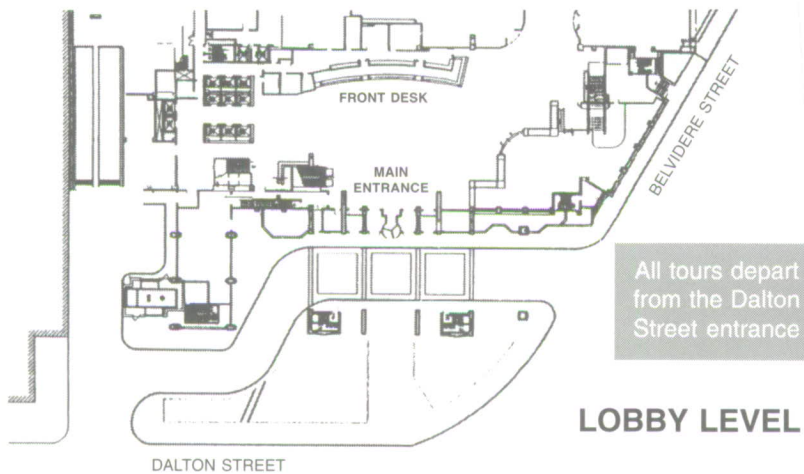

Map of Downtown Boston

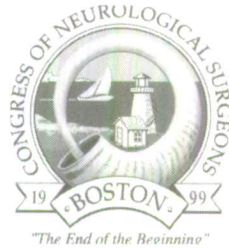

1. Westin Copley Place
2. The Hilton Boston Back Bay
3. Boston Park Plaza
4. Marriott Copley Place
5. Fairmont Copley Plaza
6. Colonnade
7. Lenox
8. Copley Square
9. Four Seasons
10. Radisson
11. John B. Hynes Veterans Convention Center

Notes

Notes

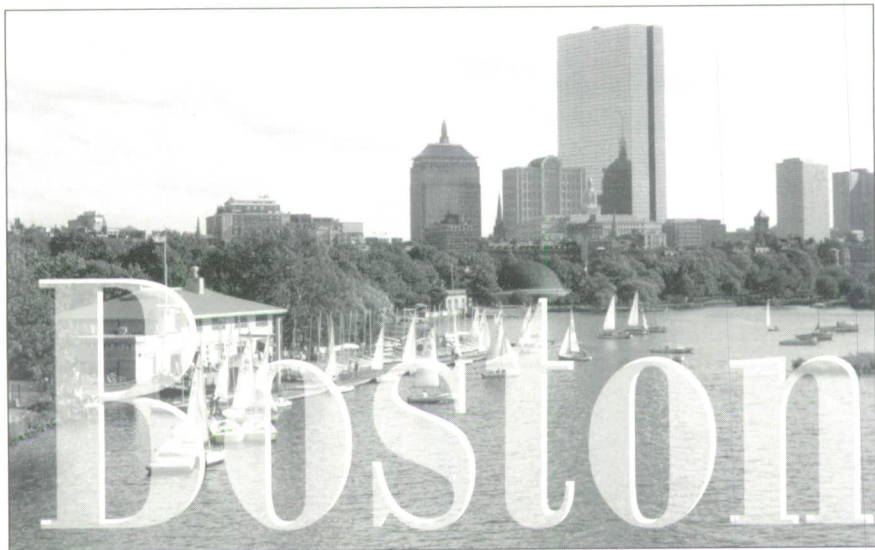

*Photos courtesy of
the Greater Boston
Convention and
Visitors Bureau*

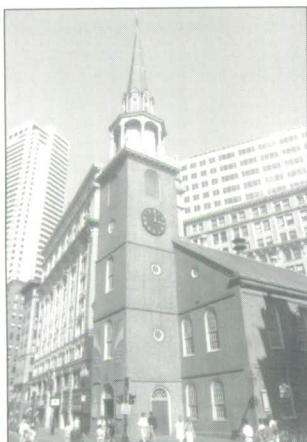



Congress of Neurological Surgeons
Annual Meeting Office
22 South Washington Street
Park Ridge, Illinois 60068-4287
Phone: (847) 692-9500
Fax: (847) 692-2589